



32 Anthony Drive

Alvaston, Derby, DE24 0FZ

£795 Per Calendar Month

FULLY BOOKED NO MORE VIEWINGS - A skilfully extended two double bedroom bay fronted detached property with gas central heating and UPVC double glazing. Accommodation comprises; reception hallway with stairs leading to the first floor, living room with feature fireplace, well equipped breakfast kitchen with integrated appliances, two double bedrooms to the first floor, family bathroom with full suite and shower, good sized garden to rear. Tarmac driveway providing ample off street car standing. Close to local amenities. No smokers. Available now.

- Two Double Bedrooms
- Extended Modern Kitchen
- Close to local schools & amenities
- AVAILABLE NOW

Viewing

Please contact our Scargill Mann & Co Residential Lettings Office on 01332 206620 if you wish to arrange a viewing appointment for this property or require further information.

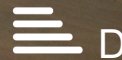

Floor Plan

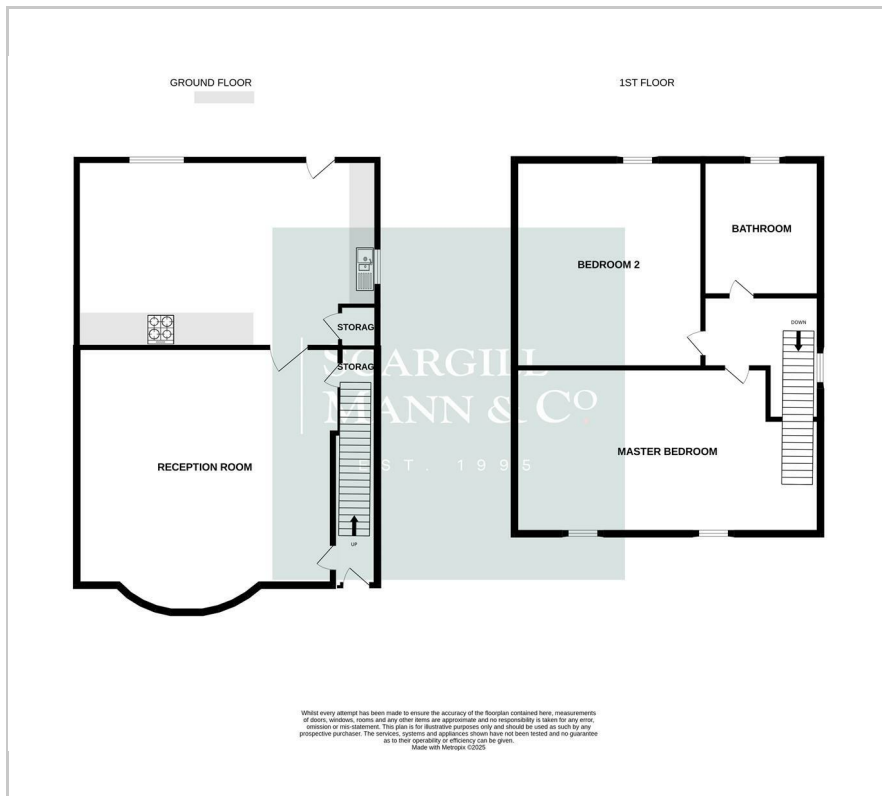

Area Map

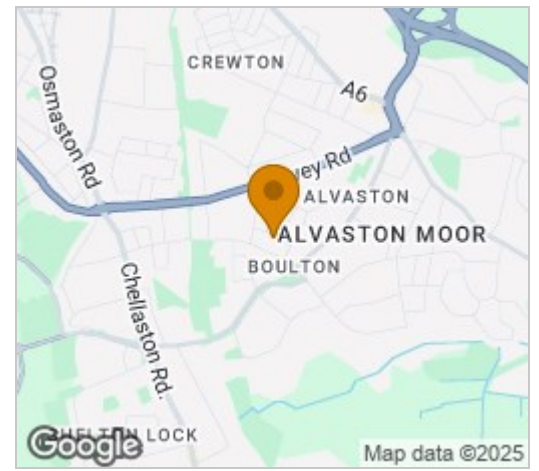

Energy Efficiency Graph

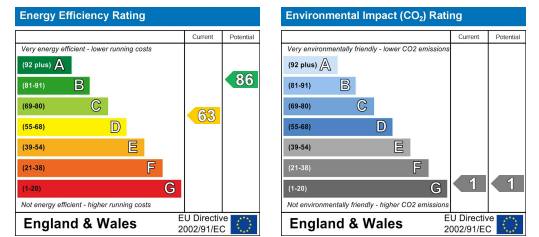

These particulars, whilst believed to be accurate are set out as a general outline only for guidance and do not constitute any part of an offer or contract. Intending purchasers should not rely on them as statements of representation of fact, but must satisfy themselves by inspection or otherwise as to their accuracy. No person in this firm's employment has the authority to make or give any representation or warranty in respect of the property.